

Executive:	MK
Manager:	MK
Designer:	MK/ST
Quality Control:	MK
Section:	Section T-XX-S R-XX-X

Professional Seal:



Know what's below.  
Call before you dig.

DATE:	ISSUE:
Date	Issue
10.11.23	FOR BIDS

**DEMOLITION & SOIL EROSION PLAN**

A.B. FORD PARK  
SNF RENOVATION

CITY OF DETROIT  
WAYNE COUNTY  
MICHIGAN

Date:	10.01.23
Scale:	1"=60'
Sheet:	CP-05
Project:	20370.10D

Copyright © 2023 Giffels Webster.  
No reproduction shall be made without the  
prior written consent of Giffels Webster.

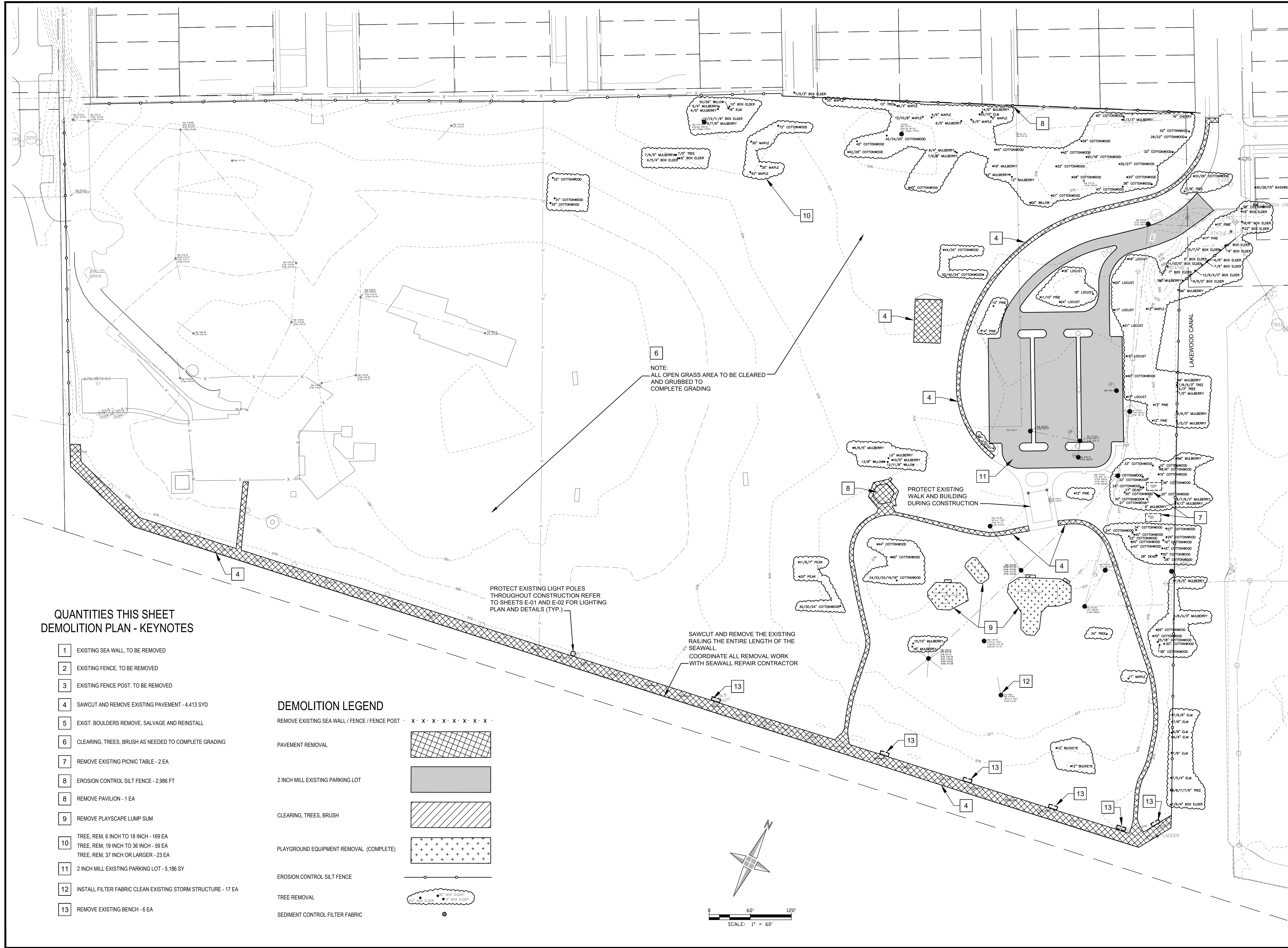

NOTE:  
ALL OPEN GRASS AREA TO BE CLEARED  
AND GRUBBED TO  
COMPLETE GRADING

PROTECT EXISTING LIGHT POLES  
THROUGHOUT CONSTRUCTION REFER  
TO SHEETS E-01 AND E-02 FOR LIGHTING  
PLAN AND DETAILS (TYP.)

SAWCUT AND REMOVE THE EXISTING  
RAILING THE ENTIRE LENGTH OF THE  
SEAWALL.  
COORDINATE ALL REMOVAL WORK  
WITH SEAWALL REPAIR CONTRACTOR

PROTECT EXISTING  
WALK AND BUILDING  
DURING CONSTRUCTION

**QUANTITIES THIS SHEET  
DEMOLITION PLAN - KEYNOTES**

- 1 EXISTING SEA WALL, TO BE REMOVED
- 2 EXISTING FENCE, TO BE REMOVED
- 3 EXISTING FENCE POST, TO BE REMOVED
- 4 SAWCUT AND REMOVE EXISTING PAVEMENT - 4,413 SYD
- 5 EXIST. BOULDERS REMOVE, SALVAGE AND REINSTALL
- 6 CLEARING, TREES, BRUSH AS NEEDED TO COMPLETE GRADING
- 7 REMOVE EXISTING PICNIC TABLE - 2 EA
- 8 EROSION CONTROL SILT FENCE - 2,986 FT
- 8 REMOVE PAVILION - 1 EA
- 9 REMOVE PLAYSCAPE LUMP SUM
- 10 TREE, REM. 6 INCH TO 18 INCH - 169 EA  
TREE, REM. 19 INCH TO 36 INCH - 59 EA  
TREE, REM. 37 INCH OR LARGER - 23 EA
- 11 2 INCH MILL EXISTING PARKING LOT - 5,186 SY
- 12 INSTALL FILTER FABRIC CLEAN EXISTING STORM STRUCTURE - 17 EA
- 13 REMOVE EXISTING BENCH - 6 EA

**DEMOLITION LEGEND**

- REMOVE EXISTING SEA WALL / FENCE / FENCE POST · · · · ·
- PAVEMENT REMOVAL
- 2 INCH MILL EXISTING PARKING LOT
- CLEARING, TREES, BRUSH
- PLAYGROUND EQUIPMENT REMOVAL (COMPLETE)
- EROSION CONTROL SILT FENCE
- TREE REMOVAL
- SEDIMENT CONTROL FILTER FABRIC

Z:\20370.10D A.B. Ford Park SNF Renovation\Design\CAD\Work Sheets\CP-05 AB Park Demolition & Soil Erosion Plan.dwg